

## EWELL GROVE PRIMARY AND NURSERY SCHOOL EWELL, SURREY

The new facilities have increased the school capacity from a 2.5 FE infant school for 4-7 year olds to a 2 FE primary school for 4-11 year olds. The school is located on a restricted site with a very narrow entrance from Ewell High Street.

Work commenced with the demolition of the existing nursery buildings

followed by the construction of a two storey building comprising reception and years 1 and 2 classrooms and a part single and two storey extension to the existing school building to provide a sports hall and kitchen.

Although within an urban setting, the site lays within a Conservation Area and an Area of High Archaeological Potential. The school building, dating from 1916 has been identified as a building of townscape merit, being designed by London architect Jarvis and Richards in the Arts and Crafts style.

Construction comprises reinforced concrete pad and traditional step foundations, and steel frame to both buildings. Features include diamond pattern roof slates, Flemish bond face brickwork, scorched hit and miss timber cladding and hidden rainwater gutters.

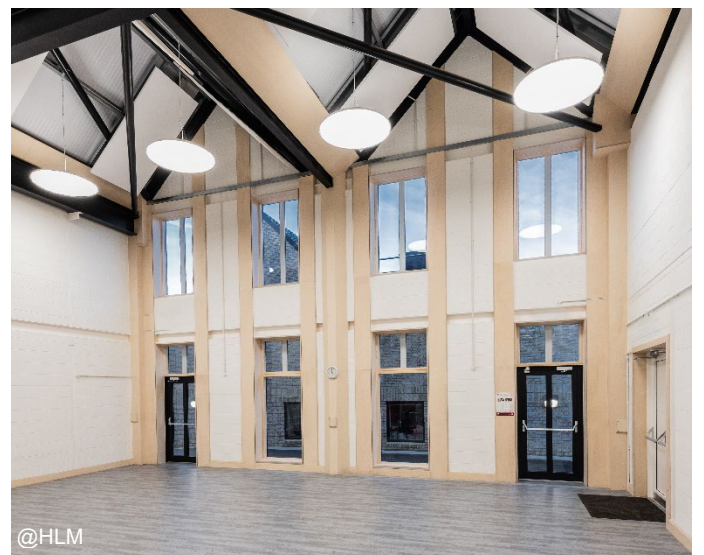

CLIENT	Surrey County Council	Kingston
ARCHITECT	HLM Architects	Southwark, London
QUANTITY SURVEYOR	WYG	Southampton
STRUCTURAL ENGINEER	WYG	Southampton
MECHANICAL ENGINEER	WYG	Southampton
ELECTRICAL ENGINEER	WYG	Southampton